

SOKIII ILLUSTRATED PARTS LIST

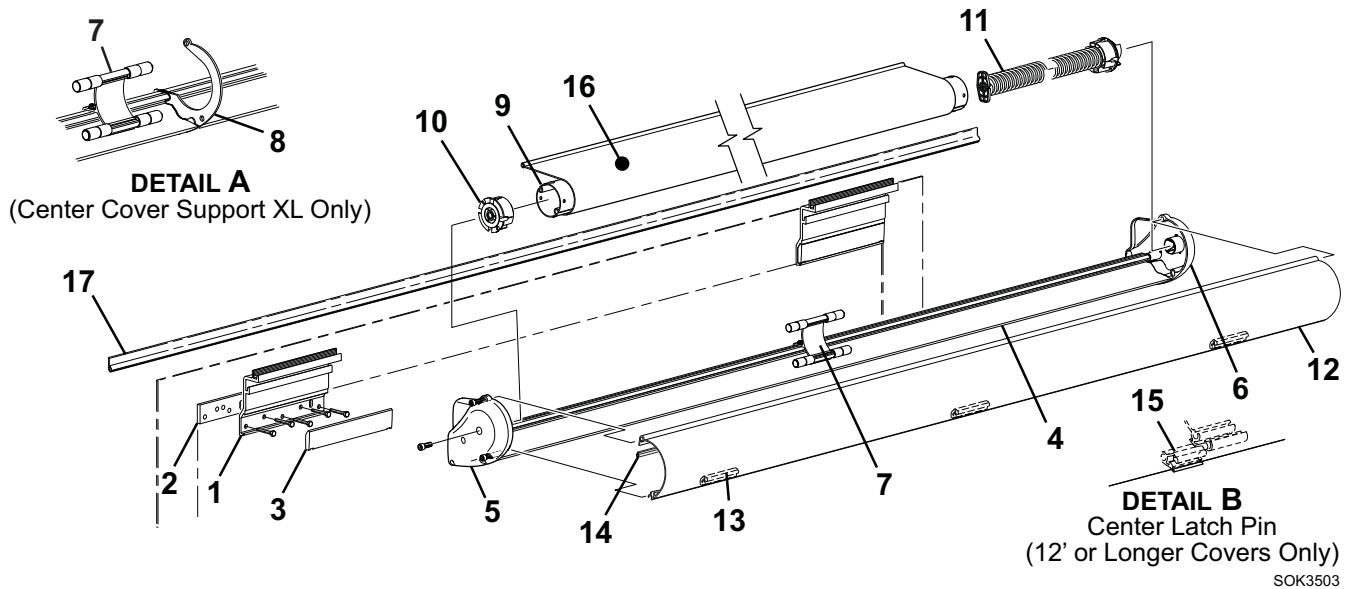

Item	Part Number	Description	Notes
1	R001150XXX	Bracket, Deflector Mount, Short	4.5" 6
2	R001534	Spacer, 1/4", Deflector Bracket	sold seperately
3	R001151XXX	Cover, Deflector Mount Bracket	
4	R001153XXX-xxx	Deflector Assy	
	R001338XXX-xxx	Deflector Assy, LH	XL Only
	R001339XXX-xxx	Deflector Assy, RH	XL Only
5	R001520XXX	End Cap, LH	Screw Cover Attach
6	R001521XXX	End Cap, RH	Screw Cover Attach
7	R001156	Roller Support	
8	R001258	Center Support Plate (includes cover attach pins)	XL Only
9	610400-xxx	Roller Tube	
	33xxx	Roller Tube Assy	XL Only 2
	R001343	Roller Tube Splice	XL Only
10	R001164	Idler Bearing, Roller Tube, LH	
11	R001165	Spring Assy	
	R001165XL	Spring Assy	XL Only
12	R001169XXX-xxx	Front Cover Assy	5
	R001337XXX-xxx	Front Cover Assy	XL Only 3,5
13	R001364	Bumper, Deflector, Rubber	pkg of 4
14	R001562	Bumper Guard	pkg of 2 4
15	R001186	Center Latch Pin	used on 12' or Longer Covers Only
16		Canopy Only	Refer to Canopy Order Form
17	0157xxx	Awning Rail	See Hardware and Accessories
18	R012711-005	Hardware Pack, White	not shown
	R012711-006	Hardware Pack, Black	not shown

- Notes:
1. XXX = Color; xxx = Length in Inches
 2. The XL replacement Roller Tube Assy includes the roller tube halves, splice, rivets, roller bearing (item 10) and pre-wound spring (item 11).
 3. XL replacement cover includes both the LH and RH halves.
 4. Set of two bumper guards (item 14) is included with canopy replacements.
 5. Replacement covers mount with screws. If replacing an older cover that uses spring pins, it will be necessary to also order end caps (items 5,6).
 6. Units 155" or less (order length) uses 2 brackets. Units 156"-191" uses 3 brackets. XL Units 283" or longer uses a quantity of 5 brackets.