



Residential

CAREFREE

EXTERIOR WINDOW SUNSHADE

110VAC MOTORIZED

Installation & Operation

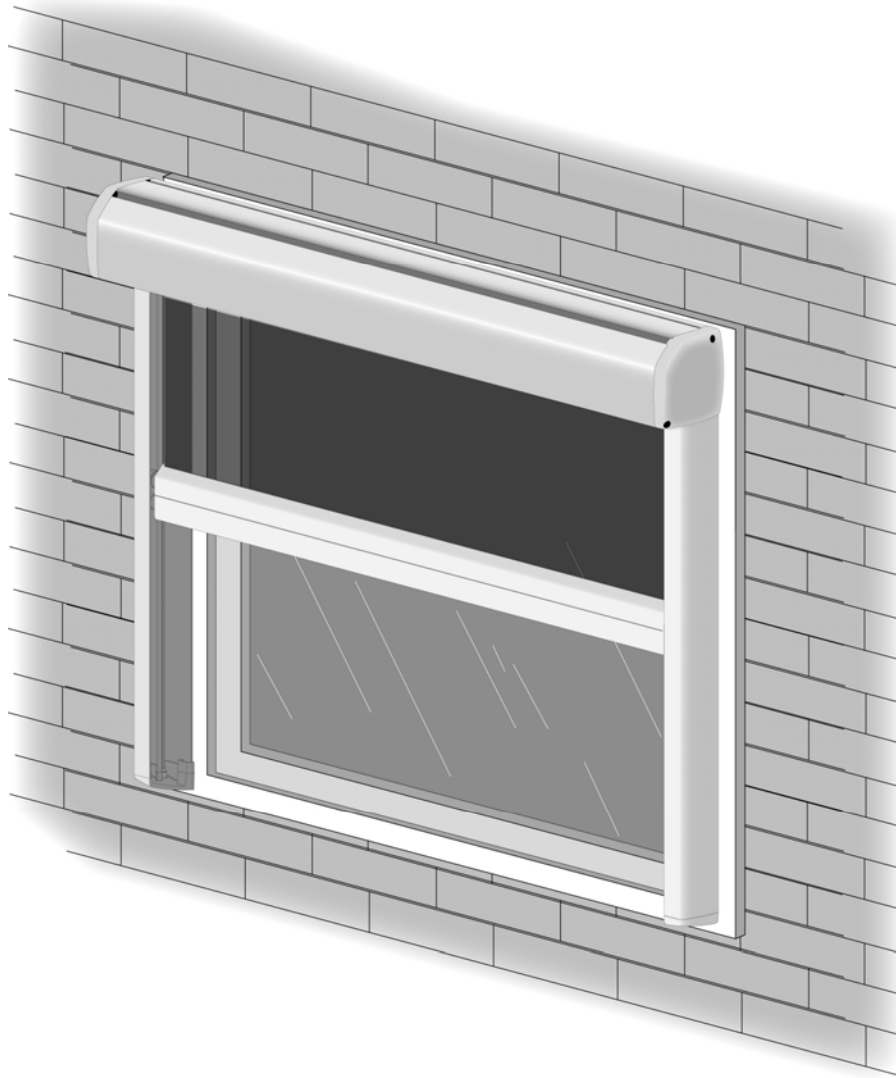

TABLE OF CONTENTS

| | |
|---|-----------|
| Introduction | 1 |
| Product Overview | 1 |
| Component Checklist..... | 2 |
| Installation | 3 |
| Installing the Brackets..... | 3 |
| Mounting the SunShade | 4 |
| Installing the Guide Rails..... | 4 |
| Wiring..... | 5 |
| Single Switch Hardwire Installation..... | 5 |
| Power Control System..... | 6 |
| Control Box Installation | 6 |
| Wireless Switch Installation | 7 |
| Programming a Transmitter..... | 7 |
| Mounting the Optional Anemometer..... | 8 |
| Testing the System..... | 9 |
| Setting the Motor Limits..... | 10 |
| Adjusting the Down Limit Switch | 10 |
| Adjusting the Up Limit Switch..... | 10 |
| Operation | 11 |
| Switch Operation – Standard Hardwire Installation | 11 |
| Using the Wireless Interior Switch | 11 |
| Using the Remote Control | 12 |
| Wind-Sense Auto Retract..... | 12 |
| Setting the Wind Speed Sensitivity..... | 12 |
| Fabric Care..... | 13 |
| Motor Maintenance..... | 13 |
| Limited Warranty..... | 14 |

SAFETY INFORMATION

WARNING

A WARNING INDICATES A POTENTIALLY HAZARDOUS SITUATION WHICH, IF NOT AVOIDED, COULD RESULT IN DEATH OR SERIOUS INJURY AND/OR MAJOR PROPERTY DAMAGE.

CAUTION

A CAUTION INDICATES A POTENTIALLY HAZARDOUS SITUATION THAT MAY CAUSE MINOR TO MODERATE PERSONAL INJURY AND/OR PROPERTY DAMAGE. IT MAY ALSO BE USED TO ALERT AGAINST UNSAFE PRACTICES.

NOTE: A note indicates further information about a product, part, or step.

Tip: A tip provides helpful suggestions.

Safety Notes:

- Always disconnect power source before working on or around the electrical system.
- Always wear appropriate safety equipment (i.e. goggles).
- Always use appropriate lifting devices and/or helpers when lifting or holding heavy objects.
- When using fasteners, use care to not over tighten. Soft materials such as fiberglass, aluminum and fiberboard can be "stripped out" and lose the ability to grip.

INTRODUCTION

PRODUCT OVERVIEW

The Carefree Exterior Window Sunshade mounts on the outside of the window. The heavy duty case protects the roller and fabric. Low profile guide rails keep the shade in place even during windy weather.

Two control systems are available: a single hard wired wall switch or the power control system. The hard wired wall switch provides basic operation.

The power control system provides the owner several options that are not available with the standard hard wired installation. These options include hand held remote controls; wireless wall switches for interior installation and the wind-sense auto retract for protection against adverse wind conditions. The power control system can also be programmed so that up to a maximum of 4 shades can be controlled by a single transmitter.

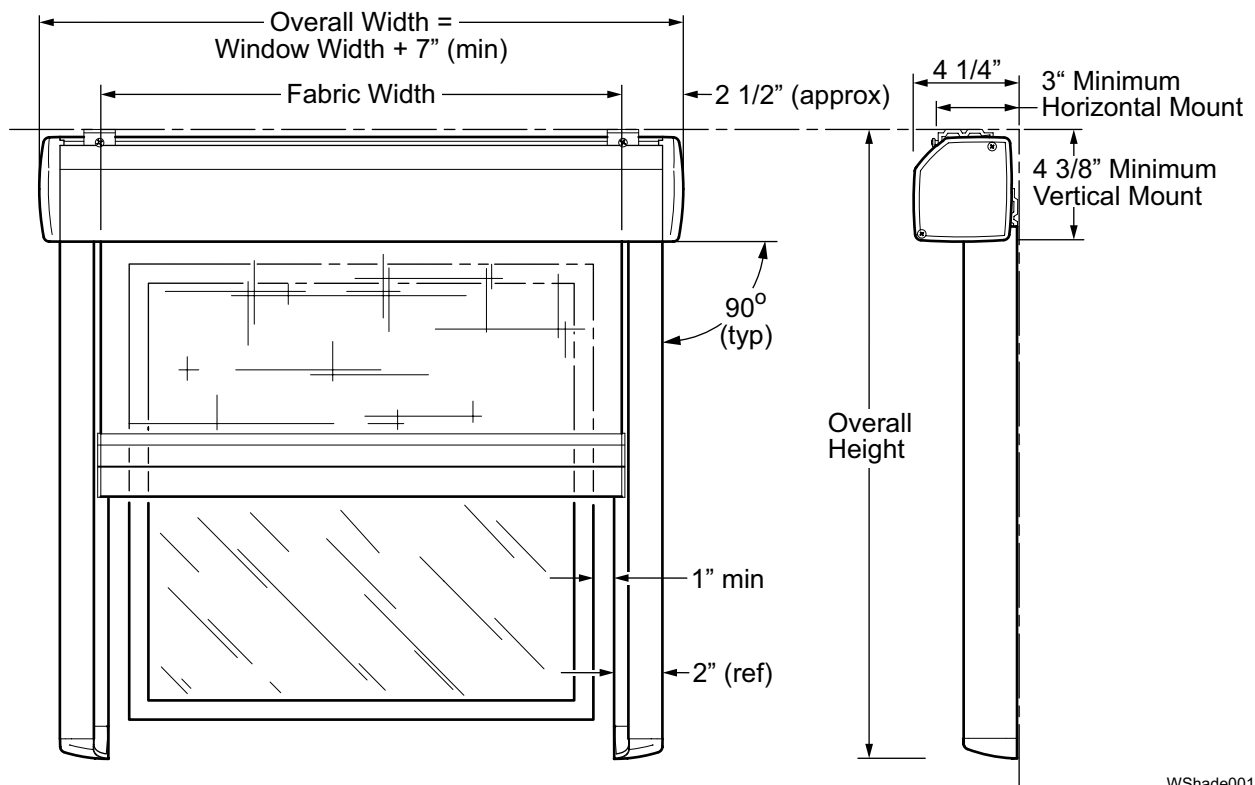

WShade001

Figure 1. General Layout.

AVAILABLE WIDTHS: 3' to 17' in 1/4" increments **DROP:** 96" Max. (92" w/ optional Sunbrella Acrylic)
OPERATION: Motorized 110VAC Tubular Motor

COMPONENT CHECKLIST

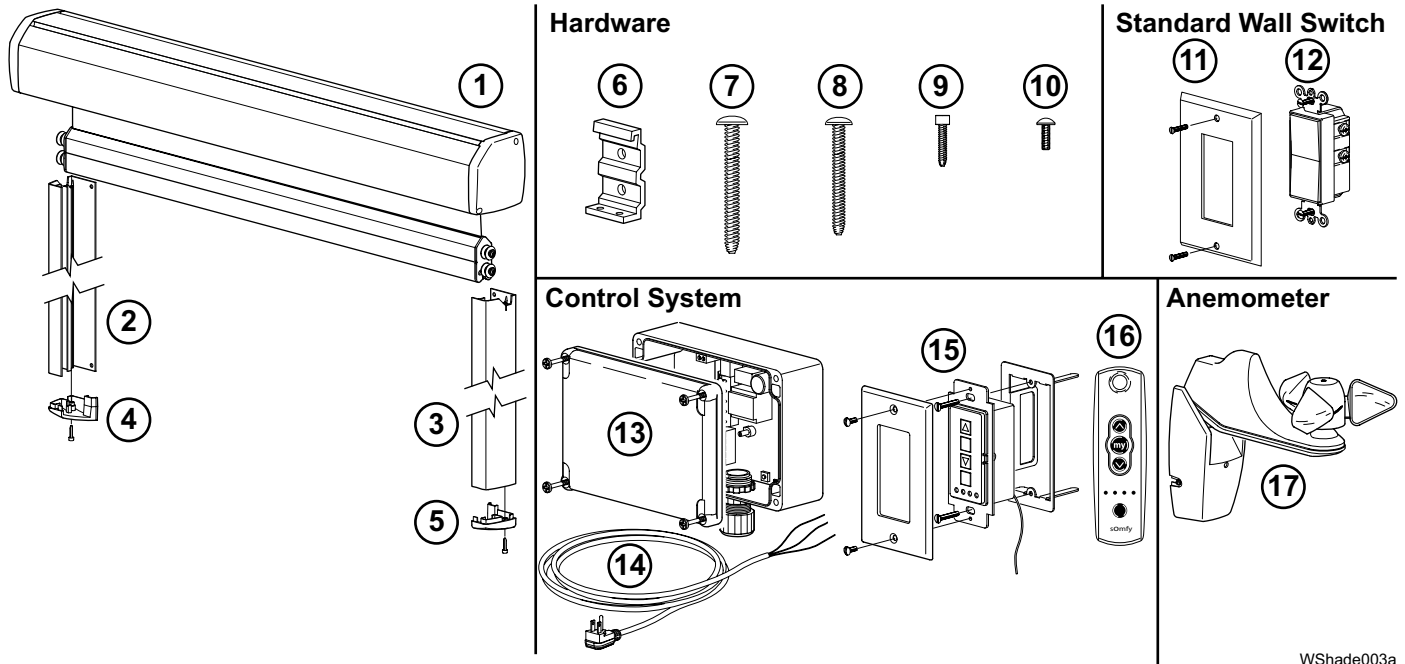

WShade003a

| <input checked="" type="checkbox"/> | ITEM | DESCRIPTION | QUANTITY | | |
|-------------------------------------|------|--|----------|----|------|
| | | | A | B | NOTE |
| <input type="checkbox"/> | 1 | SunShade Assembly | 1 | 1 | |
| <input type="checkbox"/> | 2 | Guide Rail, LH | 1 | 1 | 3 |
| <input type="checkbox"/> | 3 | Guide Rail, RH | 1 | 1 | 3 |
| <input type="checkbox"/> | 4 | End Cap, LH | 1 | 1 | |
| <input type="checkbox"/> | 5 | End Cap, RH | 1 | 1 | |
| <input type="checkbox"/> | 6 | Mounting Bracket | 3 | 5 | 2 |
| <input type="checkbox"/> | 7 | Screw, Pan Head #10 x 2 | 6 | 6 | 2 |
| <input type="checkbox"/> | 8 | Screw, Pan Head 1/4 x 2 1/2 | 6 | 10 | 2 |
| <input type="checkbox"/> | 9 | Screw, Socket Head #8-18 x 3/4 | 2 | 2 | 2 |
| <input type="checkbox"/> | 10 | Screw, #8-32 x 1/2 | 6 | 10 | 2 |
| <input type="checkbox"/> | 11 | Switch Cover, White | 1 | | 4 |
| <input type="checkbox"/> | 12 | Switch, Wall | 1 | | 4 |
| <input type="checkbox"/> | 13 | Control Box Assy | 1 | | |
| <input type="checkbox"/> | 14 | AC Power Cord w/ Wall Connector | 1 | | |
| <input type="checkbox"/> | 15 | Wireless Wall Switch | 1 | | 5, 6 |
| <input type="checkbox"/> | 16 | Remote Control (includes storage holster & screws) | 1 | | 6 |
| <input type="checkbox"/> | 17 | Anemometer (used with wind-sense auto retract) | 1 | | |

- Notes:
1. Shade configuration is specified at time of order. Check assembly and electronics against original purchase order.
 2. Hardware quantities are dependent on size:
 - A = Shade lengths 3 feet to 8 feet
 - B = Shade lengths from 8 feet to 17 feet
 3. Guide Rails are cut to the length specified at the time of order.
 4. Components used with motorized version with hardwired switch.
 5. Mounting bracket, switch plate and screws are included with switch.
 6. Wall Switch (item 18) and Remote (item 19) are available as single channel or multiple channel transmitters.

INSTALLATION

Prior to mounting the SunShade, clean and inspect the area. Standard construction uses a solid wood header across the top of an opening. If the shade is to be mounted in a different location or the header is not present, it will be necessary to locate the wall studs. If mounting in an alternate position, adjust the dimensions below to allow the bracket mounting screws to screw into the studs.

INSTALLING THE BRACKETS

The brackets may be mounted vertically (on a wall) or horizontally (under an overhang). The screws provided can be used in a variety of materials, for soft materials refer to step 4.

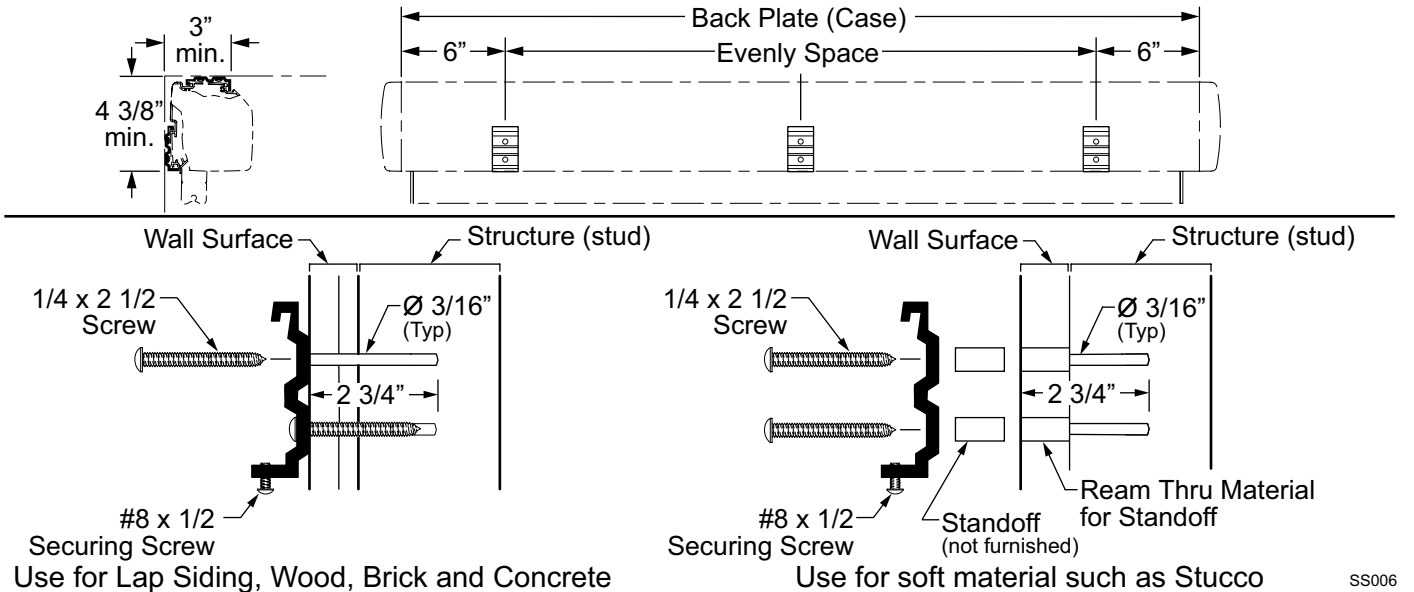

Use for Lap Siding, Wood, Brick and Concrete

Use for soft material such as Stucco

SS006

Examples shown are suggestions and may not cover all circumstances. If unsure, consult a builder or engineer prior to installation.

Figure 2. Bracket Layout and Mounting.

1. Mark the position of the shade and the brackets using a chalk line. Ensure that the brackets are in line and parallel to the ground.
2. Using the bracket as a template, drill 2 3/16" pilot holes. The hole should be at least 1/4" deeper than the length of the screw (approximately 2 3/4").
3. FOR SOFT OUTER MATERIALS SUCH AS STUCCO. Use a standoff large enough to allow the 1/4" screw to pass through with a length equal to the depth of the material. It will be necessary to ream out the hole through the soft material only (e.g. stucco).

NOTE: This will prevent the bracket from crushing or sinking into the outer wall material.

4. Attach the brackets using the 1/4 x 2 1/2 screws. Ensure that the brackets are in line and perpendicular to the length of the shade.
5. If not previously done, start the #8 x 1/2 securing screws in the brackets. Do not screw in fully.

MOUNTING THE SUNSHADE

⚠ CAUTION

BECAUSE OF THE WEIGHT OF THE SHADE, IT IS RECOMMENDED THAT TWO PEOPLE LIFT AND HOLD THE SHADE.

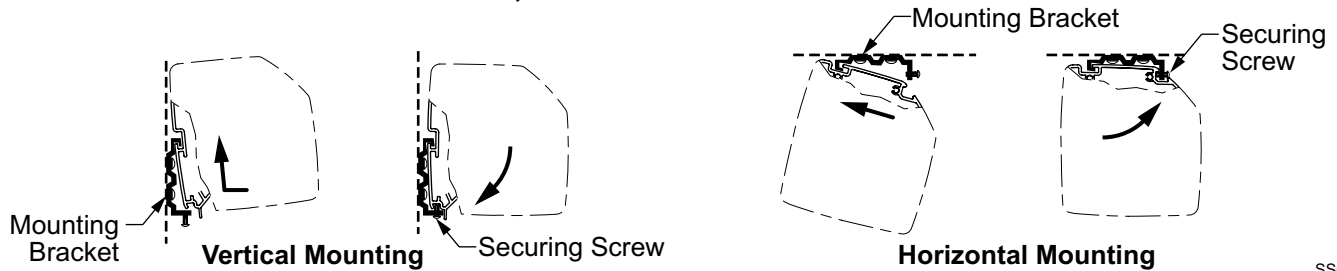

SS005

Figure 3. Mounting the SunShade.

1. Lift the shade up and tilt as shown in the illustration.
2. Hook the shade cover into the hook of the mounting bracket.
3. Rotate the shade into position.
4. Adjust the position of the shade as required.
5. Tighten the securing screws in the mounting brackets.

INSTALLING THE GUIDE RAILS

NOTE: For ease of testing and installation, install the guide rails AFTER completing the wiring in the next section.

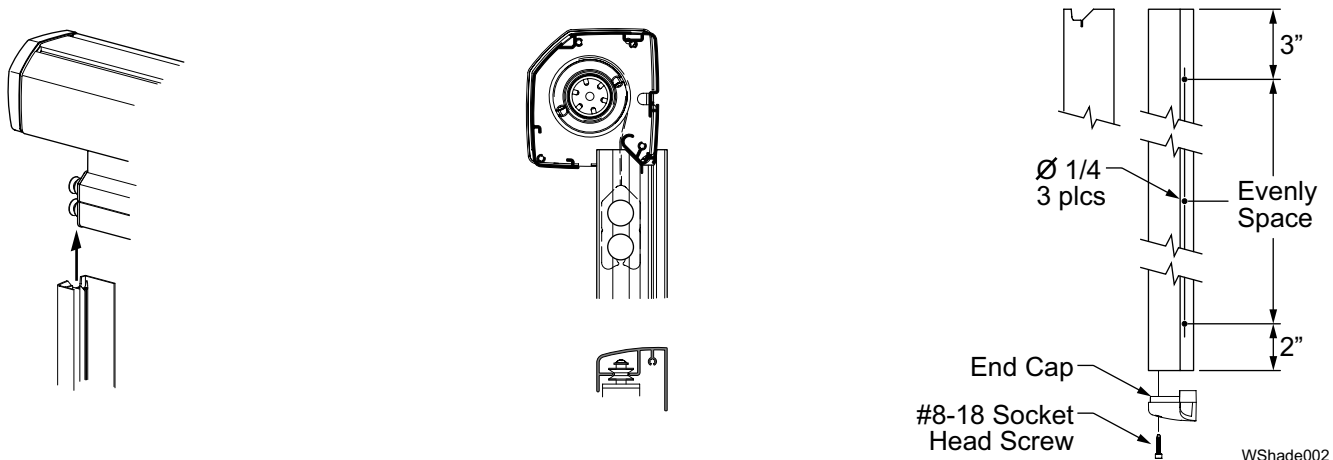

WShade002

Figure 4. Installing the Guide Rails.

1. Lower the shade approximately 6".
2. The end caps are temporarily taped to the guide rails. Remove the end caps and set aside.
3. On the back side of the rails, use a non-permanent method of marking and mark the location of the mounting holes as shown. Do not drill at this time. Note that the top of the rail is the one with the notch in it.
4. Lift the guide rail up and slide the lead rail guide rollers into the track of the guide rail. Lift the rail up until it is firmly seated against the shade case as shown and to the inside of the end cap.
5. Make sure that the guide rail is perpendicular to the shade and mark the position. Confirm that the marks made in step 3 will match the building structure, adjust as necessary.
6. Remove the rail and drill three (3) 1/4" holes at the marks from step 3. Clean and deburr as required.
7. Snap the end cap onto the bottom of the guide rail and attach using one #8-18 x 3/4 socket head screws.
8. Position the rail using the position marks from step 5. Be sure to place the guide rollers in the track.
9. Using the guide as a template, drill three (3) 1/8" pilot holes into the structure then attach the guide rails using three (3) #10 x 2 screws.
10. Repeat steps 3 through 9 for the second guide rail.

WIRING

⚠ WARNING

ALWAYS DISCONNECT THE ELECTRICAL SOURCES BEFORE WORKING WITH ELECTRICAL WIRING AND COMPONENTS.

The 110VAC motorized Carefree SunShade is available with two power options.

- A single hardwired switch; or,
- Power Control System. The system offers several options that are not available with the standard hard wired installation. These options include remote controls; wireless wall switches for interior installation and the wind-sense auto retract for protection against adverse wind conditions.

Important Notices:

- Failure to follow the wiring instruction in this publication may void the motor warranty.
- All wiring must conform to NEC (National Electrical Code) and the prevailing building codes of the area.
- Do not wire two or more motors to one switch or control box – No parallel wiring.
- It is strongly recommended that wiring be done by a qualified electrician.
- The installer must furnish required UL approved junction boxes, conduit etc. where required.

SINGLE SWITCH HARDWIRE INSTALLATION

- Determine the location of the switch and junction boxes. The following cable lengths should act as a guide for locating the components:
 - 8 feet of cable from shade motor (attached to motor);
 - 12 feet of 2 conductor 18AWG cable w/ ground and standard grounded plug;
 - The installer must furnish the 3 conductor cable w/ ground that runs from the junction box to the switch box.
- Attach the appropriate junction and switch boxes in the desired location.
- Route the cables as shown and connect the wires with standard wire nuts. Be sure to match wire colors; white to white (neutral), black to black (line) and green to green (ground).

Note: Form drip loops at the motor and junction boxes to avoid water following the cables into the components.

- Connect wires to the switch and install switch and cover.

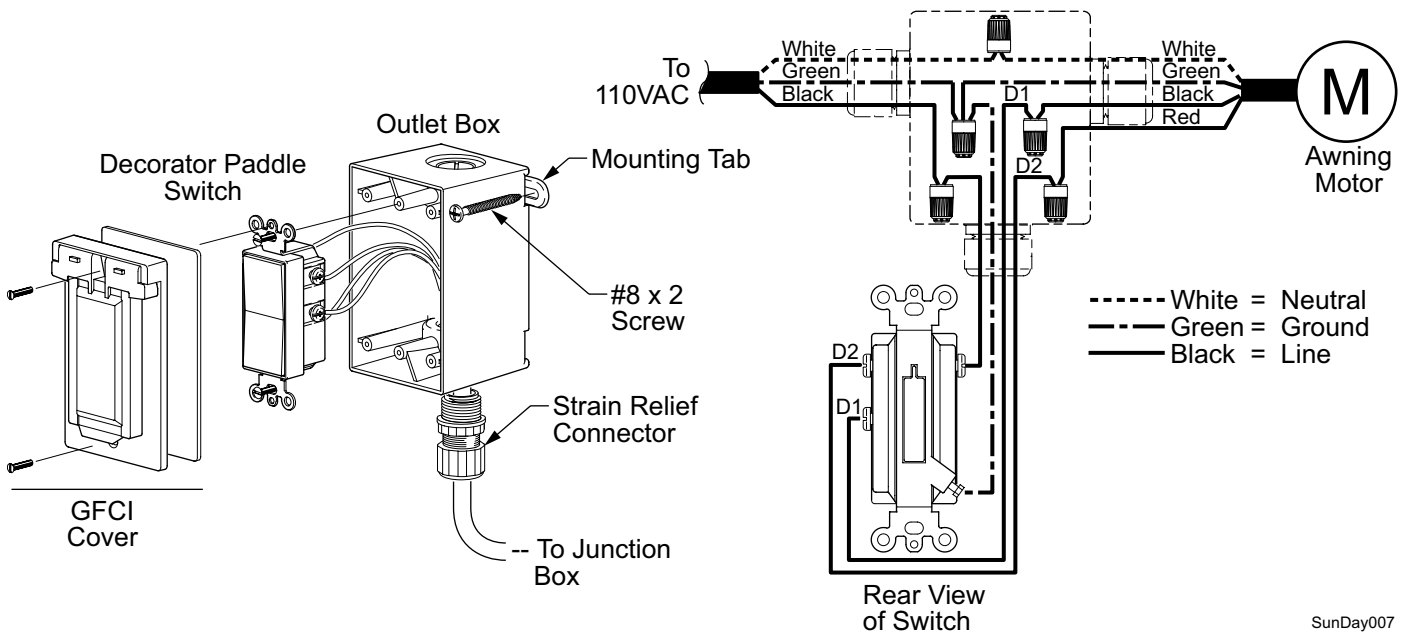

Figure 5. Single Switch Installation.

SunDay007

POWER CONTROL SYSTEM

The power control system provides the home owner several options that are not available with the standard hard wired installation. These options include remote controls; wireless wall switches for interior installation and the wind-sense auto retract for protection against adverse wind conditions.

Control Box Installation

The control box is used when the installation uses a wireless remote, wireless switch or anemometer. For multiple shade applications, each unit must have a dedicated control box. Multiple shades cannot be controlled by a single control box.

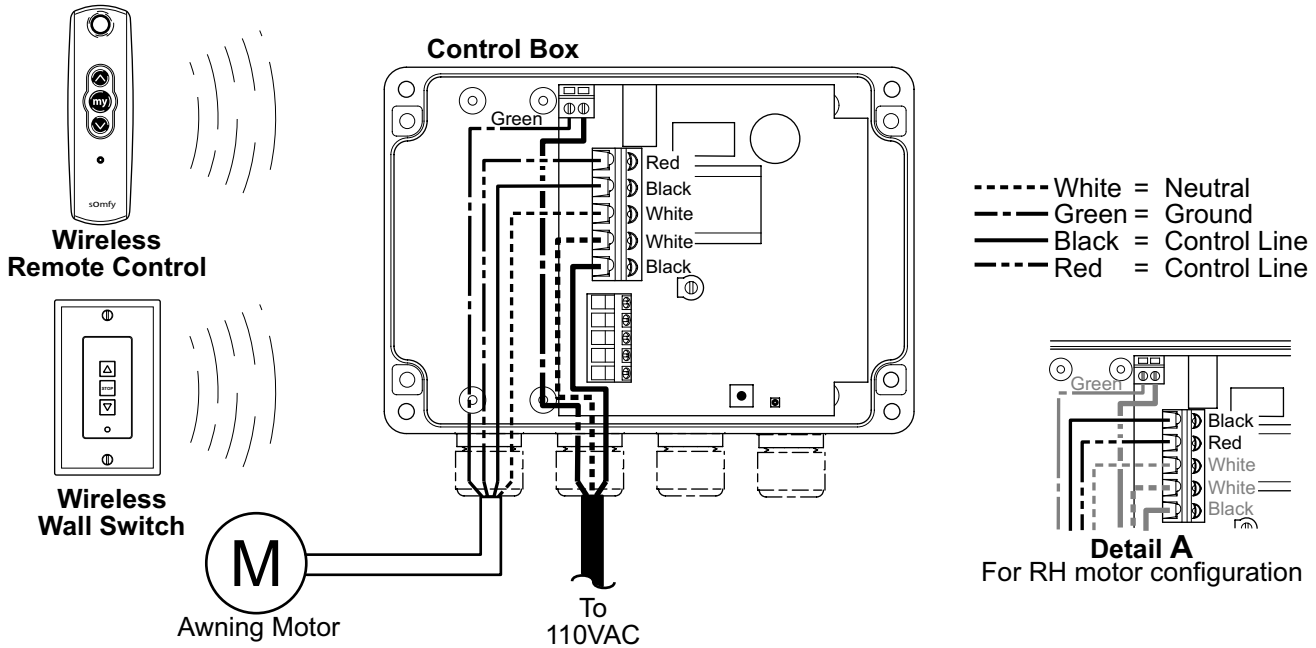

SS014a

LH Motor Configuration Shown. Use Detail A for RH Motor Configurations.

Figure 6. Control Box Wiring Diagram.

1. Determine the location of the control box.
 - Mount the box as close to the motor as possible.
 - The following cable lengths should act as a guide for locating the components:
 - 8 feet of cable from shade motor (attached to motor);
 - 12 feet of 2 conductor 18AWG cable w/ ground and standard grounded plug;
 - Do not mount the box on or next to metal surfaces. This can affect radio reception.
 - When mounting the box outside, ensure that the cable entry glands are pointed down to avoid moisture seepage.
2. Remove the front cover of the control box.
3. Attach the box using a minimum of two (2) #8 x 2 screws. The screws should be mounted in opposite corners.
4. Route the 2-conductor 18 AWG wire w/ ground into the box. Connect wires to the control box as shown in the wiring diagram.
5. Route the cable wire from the shade motor to the control box and connect the wires as shown.

Note: Form drip loops at the motor and control box to avoid water following the cables into the components.
6. Do not attach the control box cover at this time.

Wireless Switch Installation

CAUTION

THE WIRELESS WALL SWITCH IS DESIGNED AS AN INTERIOR SWITCH ONLY. MOUNTING THE SWITCH OUTSIDE OR IN AN AREA DIRECTLY INFLUENCED BY ADVERSE ENVIRONMENTAL FACTORS CAN CAUSE PREMATURE DAMAGE TO THE SWITCH AND VOID WARRANTY.

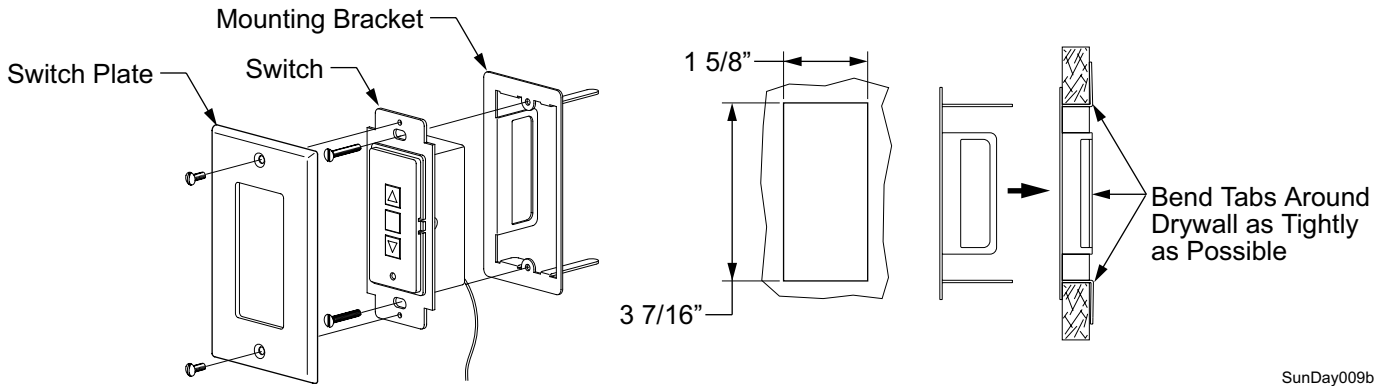

Figure 7. Mounting the Wireless Switch.

1. Determine the location of the switch. The switch should be positioned so that the operator can see the shade operate.
2. Carefully cut a hole 1 5/8" wide x 3 7/16" tall into the wall.
3. Press the mounting bracket into the hole and bend the bracket tabs tightly around the drywall as shown.
4. Program the switch and control box. Refer to "Programming a Transmitter" on page 7.
5. After programming is complete, attach the switch and switch plate to the mounting bracket using the furnished screws.
6. If all options are installed, attach the control box cover.

Programming a Transmitter

The wireless wall switch and hand held remote are both available as a single channel or multiple channel. A single channel transmitter controls one shade, the multiple channel transmitter can control up to 4 separate units individually or as a group. Transmitters require a control box installed.

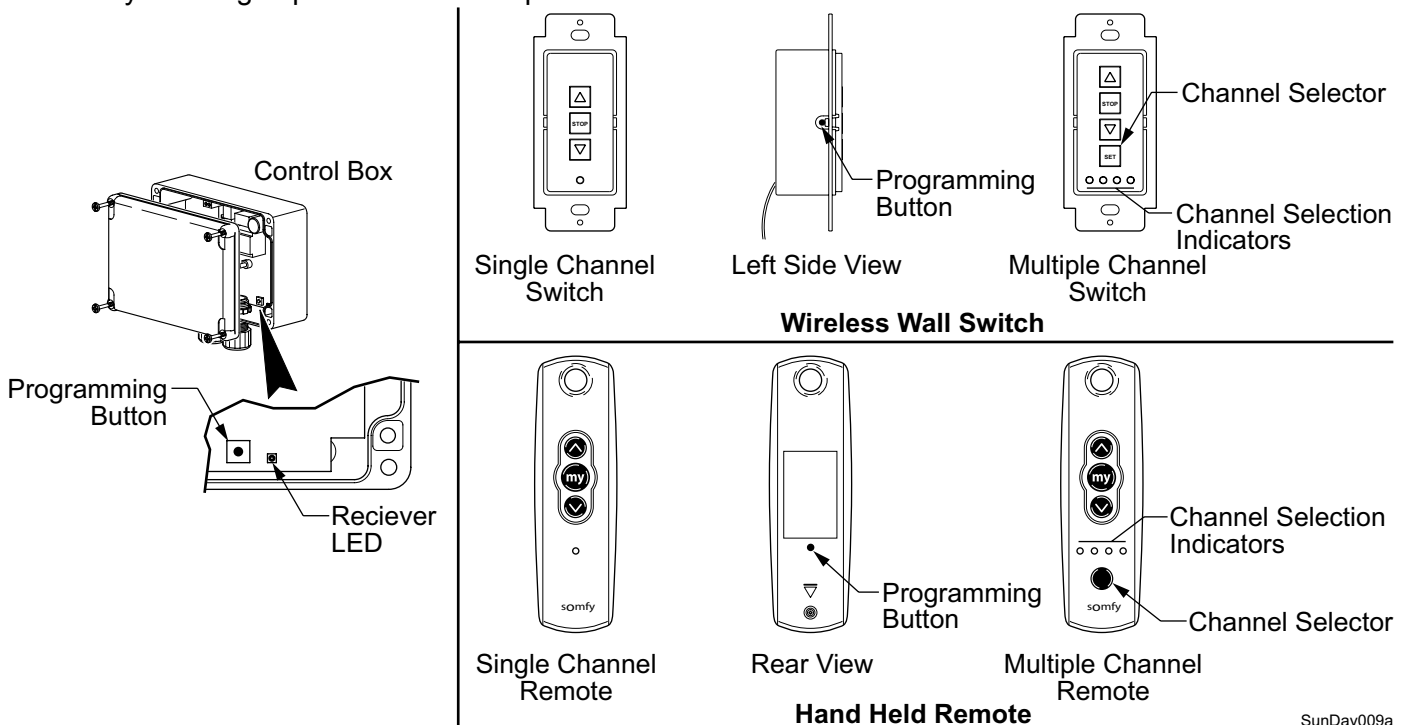

Figure 8. Programming a Transmitter.

1. Connect control box to power source (110VAC).
2. Press the Programming Button (PROG) of the receiver located in control box (lower right corner) until LED illuminates. This indicates that for one (1) minute the receiver is ready to receive the address of the transmitter. After this time, the control box exits the programming mode and the LED goes out.
3. For multiple channel transmitters, use the channel selector until the 1st channel (LED) is illuminated.
4. Press the Programming Button on the transmitter with a ballpoint pen until the receiver's LED blinks rapidly and shuts off. The address of the transmitter is instantly memorized and the receiver automatically ends the programming mode.
5. For multiple channel transmitters:
 - To set the group control, Use the channel selector until all 4 LEDs are blinking, this is the group (master) channel. Repeat steps 5 & 7.
 - Repeat the above steps for each control box using the channel selector to set the channel to #2 for the second control box, #3 for the third control box and #4 for the fourth box. For each control box also set the master channel.
6. Test operation. The "UP" arrow should retract the shade; the "DOWN" arrow should extend the shade. If the shade works opposite the switch markings, reverse the red and black motor wires in the control box.

IMPORTANT NOTE: The shade must operate as described if the wind-sense auto retract is installed. If the shade operates in reverse of the markings, the system will try to extend the shade instead of retracting the shade.

NOTES FOR SWITCHES AND REMOTES

- Transmitters operate on a frequency of 433.42 MHz.
- Transmitters use a 3V Lithium Battery (CR 2430)
- Maximum operating range is 65 ft. Actual distance may vary based on installation.
- The control box may be programmed for up to 12 transmitters (switches and remotes).
- Programming additional transmitters may be accomplished as described previously or can be done using the existing transmitters. To use an existing transmitter: press the programming button of the existing transmitter for 3 seconds then press the programming button of the new transmitter for 1 second (max).

Mounting the Optional Anemometer

The optional wind-sense auto retract system uses an anemometer to measure wind speed. When the wind reaches the user set value, the shade will automatically retract.

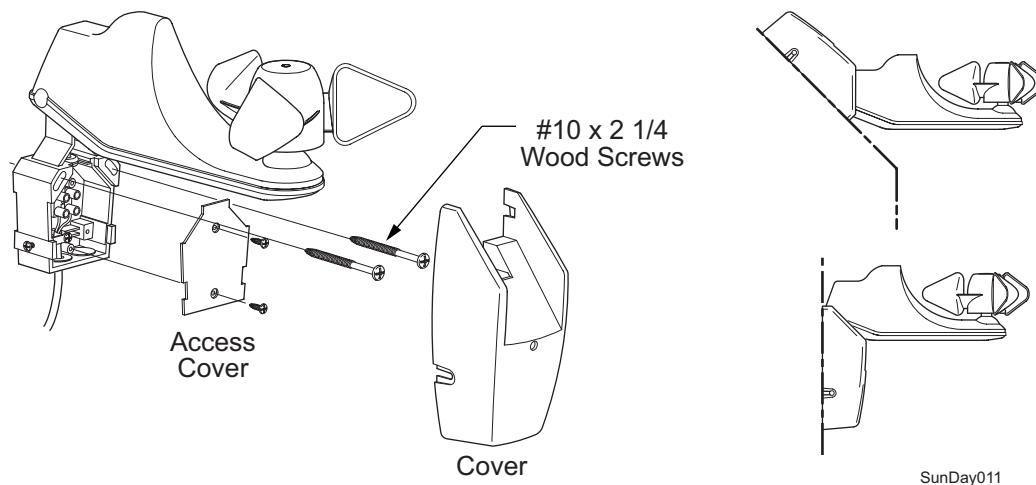

Figure 9. Mounting the Anemometer.

1. Remove the outer cover and the access cover.
2. Knock out one of the holes at the bottom of the base.
3. Route the furnished cable through the hole and under the clamp plate in the base.
4. Attach the wires to the terminals as shown in the wiring diagram. The wire colors are not pin specific.

5. Reattach the access cover.
6. Determine the mounting location of the anemometer.
 - The anemometer may be mounted to a vertical surface or sloped surface;
 - Ensure that the cups are horizontal. Do not mount upside down;
 - The position should be exposed to the same wind elements as the shade.
7. Mount the unit using the supplied wood screws.
8. Install the outer cover over the base.
9. Route the cable to the control box and connect the wires as shown.

Testing the System

1. Plug the power cord into an active power receptacle (110VAC).
2. On the transmitter (wireless switch or remote), press and release the DOWN arrow. The shade should extend.
3. Press and release the stop (center) button. The shade should stop.
4. Press and release the UP arrow. The shade should retract and stop automatically when fully closed.

If the shade does not operate as described:

- If the shade moves in a direction opposite than described; in the control box, reverse the red and black wires from the motor.
- If the shade does not operate using the transmitter; program the remote following the directions on page 7.
- If the shade does not operate, check power in and all wiring connections, correct as required.

Testing the wind sense auto-retract function. (This test assumes the previous tests were successful.)

1. Set the wind speed sensitivity to the lowest wind speed. Refer to page 12.
2. Extend the shade approximately half way.
3. Spin the anemometer. The shade should retract automatically to the closed position.

NOTE: Do not hit the anemometer to spin. Using compressed air provides a constant pressure source and, the output can be regulated to test the various sensitivity settings. DO NOT position the nozzle closer than 10 inches from the cups.

4. Repeat steps 2 and 3 two (2) more times with the sensitivity set at the medium and high wind settings.

If the shade does not respond:

- Check that the wiring from the anemometer and control box is good and that the cups are not blocked.
- If the shade opens instead of closes; in the control box, reverse the red and black wires from the motor.

SETTING THE MOTOR LIMITS

The motor limit switches have been preset at the factory for best operation. The "DOWN" limit switch is used to stop the motor when the shade is extended. The "UP" limit switch is used to stop the motor when the shade is fully retracted.

The limit switches are located inside the case, near the end cap.

When the shade is extended, the motor should stop and the fabric should be tight. If the motor continues to run, the fabric will sag; or, if the motor stops before the fabric is fully extended, it will be necessary to adjust the "DOWN" limit switch.

When the shade is retracted, the motor should stop when the shade is fully retracted. If the motor continues to run; or, if the motor stops before the fabric is fully retracted, it will be necessary to adjust the "UP" limit switch.

NOTE: It is best to make the adjustments in increments of a single turn. 3 full turns of the screw equals approximately 2" of fabric extension.

Adjusting the Down Limit Switch

1. Extend the shade completely.
2. Using a 4mm Allen wrench, turn the "DOWN" limit switch. Clockwise decreases time the motor runs during extension, counterclockwise increases the time the motor runs.
3. Extend and retract the shade several times to confirm that the adjustment is correct.
4. Repeat steps 3 & 4 as required until the shade extends correctly.

Adjusting the Up Limit Switch

1. Retract the shade completely.
2. Using a 4mm Allen wrench, turn the "DOWN" limit switch. Clockwise decreases time the motor runs during extension, counterclockwise increases the time the motor runs.
3. Extend and retract the shade several times to confirm that the adjustment is correct.
4. Repeat steps 3 & 4 as required until the shade retracts correctly.

NOTE: The tubular motor is not continuously rated. A built in thermal overload device protects the motor from over heating. If the motor continues to run for an extended period of time, the device will shut down the motor. It will be necessary to allow the motor a 15 minute "cool down" period before operation can resume.

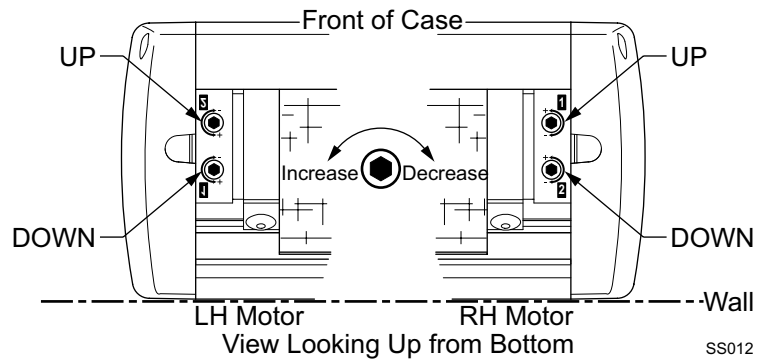
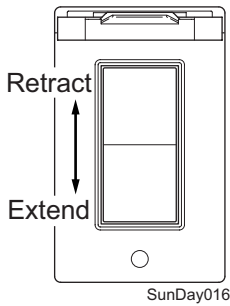

Figure 10. Motor Limit Switches.

OPERATION

SWITCH OPERATION – STANDARD HARDWIRE INSTALLATION



- Press and hold the switch down to extend the shade to the desired extension.
- Press and hold the switch up to retract the shade.

USING THE WIRELESS INTERIOR SWITCH

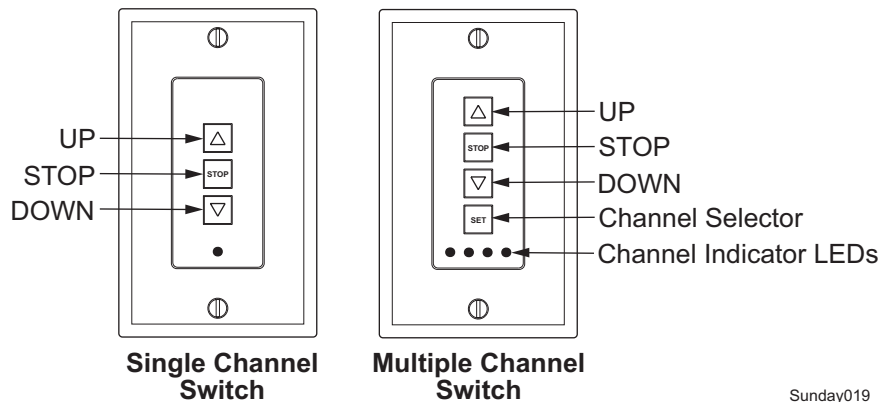

Figure 11. Wireless Switch.

- UP Press and release the UP arrow to retract the shade. The shade will retract until fully closed.
 - STOP Press the center button to stop the shade during extend or retract functions.
 - DOWN..... Press and release the DOWN arrow to extend the shade. The shade will extend to the maximum extension.
 - Channel Selector .. For multiple channel switches: Press the "Channel Selector" until the corresponding selection indicator LED is illuminated for the shade to be operated.
- When all 4 indicator LEDs are illuminated the remote is in "Group" mode. All shades will respond to the command buttons as a group (i.e. pressing the DOWN button will cause all shades to extend).

The wireless switch uses a flat 3V Lithium Battery (CR2430) that should provide a long period of service. To replace: Remove the switch from the wall mount. On the back remove the box (2 screws). Slide the old battery from the battery holder and slide a new battery in. Pay attention to the polarity of the battery. Batteries are available through local battery outlets.

USING THE REMOTE CONTROL

- UP Press and release the UP arrow to retract the shade. The shade will retract until fully closed.
- STOP Press the center button to stop the shade during extend or retract functions.
- DOWN..... Press and release the DOWN arrow to extend the shade. The shade will extend to the maximum extension.
- Channel Selector .. For multiple channel remotes: Press the "Channel Selector" until the corresponding selection indicator LED is illuminated for the shade to be operated.

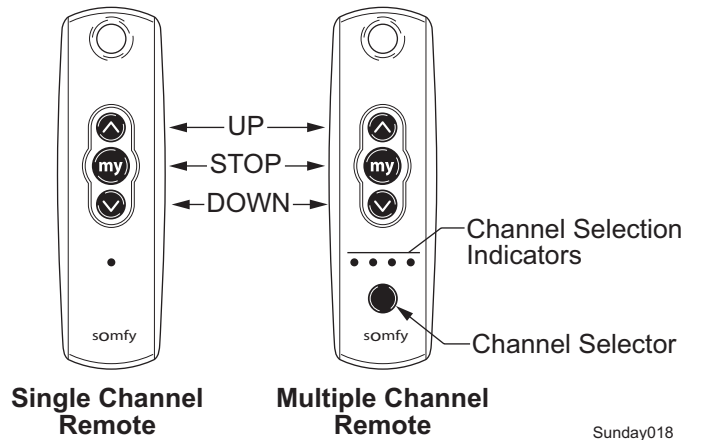

Figure 12. Remote Control.

Sunday018

When all 4 indicator LEDs are illuminated the remote is in "Group" mode. All shades will respond to the command buttons as a group (i.e. pressing the DOWN button will cause all shades to extend).

The remote uses a flat 3V Lithium Battery (CR2430) that should provide a long period of service. To replace: Remove the screw and back of the remote. Slide the old battery from the battery holder and slide a new battery in. Pay attention to the polarity of the battery. Batteries are available through local battery outlets.

WIND-SENSE AUTO RETRACT

The optional wind-sense auto retract system uses an anemometer to measure wind speed. The system is always on when the shade is extended. When the wind reaches the user set value, the shade will automatically retract.

When the wind speed exceeds the set value for longer than 2 seconds, the retract command is activated. While the wind speed exceeds the set value, all extend and stop commands are ignored. When the wind speed drops below the set value, operation will return to normal after a brief delay.

⚠ CAUTION

THE WIND-SENSE AUTO RETRACT SYSTEM IS A PREMIERE ELECTRONIC AUTO-RETRACT SYSTEM THAT PROVIDES PROTECTION AGAINST ADVERSE ELEMENTS; BUT NO AUTO-RETRACT SYSTEM IS A GUARANTEE AGAINST SEVERE OR DESTRUCTIVE WEATHER; THE EFFECTS OF WIND AND RAIN ON AN SHADE ARE UNPREDICTABLE AND MAY CAUSE SEVERE DAMAGE TO THE SHADE AND/OR BUILDING. IF WIND OR EXTENDED PERIODS OF RAIN ARE EXPECTED, RETRACT THE SHADE.

Setting the Wind Speed Sensitivity

The wind sensitivity can be set for a preferred wind speed.

1. Open the control box.
2. In the center of the control board, locate the speed adjust switch.
3. Turn the switch to the desired setting. Turning to the left increases sensitivity (less wind); turning to the right decreases sensitivity (higher wind). The label next to the switch gives approximate values in miles per hour.

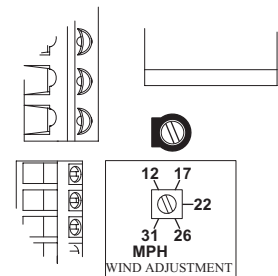

Sunday012

Figure 13. Setting Wind Sensitivity.

FABRIC CARE

CAUTION

DO NOT USE OIL BASED CLEANERS OR ANY CAUSTIC, GRANULATED, OR ABRASIVE TYPE CLEANERS ON YOUR CAREFREE PRODUCT.

1. One of the best ways to keep the fabric looking good and to delay the need for deep or vigorous cleanings is to hose fabrics off on a monthly basis with clear water. This practice will help prevent dirt from becoming deeply imbedded in the fabric. In most environments, a thorough cleaning will be needed every two to three years.
2. When it's time for a thorough cleaning, the fabric can be cleaned while still on an shade frame.
 - For Acrylic Fabric – Use a stiff brush and warm water with soap.
3. When cleaning the fabric, it is important to observe the following:
 - Always use a natural soap, never detergent.
 - Water should be cold to lukewarm, never more than 100°F.
 - Air-dry only. Never apply heat to the fabric.
 - Always allow the fabric to dry thoroughly before rolling up the shade.

Mildew

Mildew is a fungus growth that looks like dirt. Vinyl coated polyester fabrics are mildew resistant because of a chemical biocide in the vinyl coating. Under ordinary conditions, mildew will not appear. However, in areas where high temperature and humidity are common, mildew can be a problem and required the material to be washed more frequently. Thoroughly rinse the fabric with clean water and allow to air dry completely before rolling up the shade.

Hardware Maintenance

- Replace any parts that become damaged.
- Periodically check all mounting hardware, screws, lags, etc., and re-tighten when necessary.

MOTOR MAINTENANCE

- Check all wiring and connections for wear. Repair when needed.

LIMITED WARRANTY

Carefree of Colorado (hereafter referred to as Carefree) warrants to the FIRST retail Purchaser that the Exterior Window Sunshade is free of defects in material and workmanship within the terms and conditions as set forth below. Carefree's obligation under this warranty is limited to the repair or replacement, at Carefree's option, of any defective component within the stated warranty period. THIS WARRANTY IS NOT TRANSFERABLE.

1. DURATION

- a) 5 years on motor and canopy.
- b) 10 years on springs, rollers and hardware.
- c) 12 months on electronic components.
- d) For the first 12 months, should a failure occur and the initial purchaser has proof of purchase (warranty card sent in or receipt of purchase) and notifies Carefree in a timely manner, all components, labor and freight are covered 100%.
- e) After the initial 12 months, any defects in the product will be replaced or repaired for a prorated amount of the cost of the part based upon the number of months since the initial date of purchase.

Warranty duration is not extended by the length of time the product is not in use or the time which the purchaser is deprived the use of the product. The duration of coverage is determined by the date of the original product purchase, not the date of repairs.

2. WHAT IS COVERED UNDER THIS WARRANTY

Defects in the manufacturer's material and workmanship of product under normal use, and which occur within the duration of the warranty period. The following components are covered only as listed:

- a) *Fabrics* – Free from quality defects (normal wear and fading are excluded). Cracking, peeling, hardening, sagging or loss of strength provided that the damage is not the result of high winds or water pooling.
- b) *Roller tube & Hardware* – Free from extrusion defects.
- c) *Motor assemblies and Electronics*– Defects.

3. WHAT IS NOT COVERED UNDER THIS WARRANTY

- a) Fabric damage such as pinholes or tears not reported within ten (10) calendar days of purchase.
- b) Improper installation and/or any damage or failure that results from improper installation of the product, including fabric damage caused by improper installation.
- c) Normal wear including the occasional need to re-tension the shade.
- d) Conditions that are not related to the material or workmanship of the product: including any failure that results from an accident, wind, rain, water pooling, or other acts of God.
- e) Purchaser's abuse, including but not limited to neglect; failure to operate, use or maintain the product in accordance with the instructions provided with the product.
- f) Any component not sold or manufactured by Carefree.
- g) Any failure that results from the use of another manufacturer's product with a Carefree product that is not specifically approved by Carefree.
- h) Any incidental, indirect, or consequential loss, damage, or expense that may result from any defect, failure, or malfunction of the Carefree product.
- i) The removal or alteration of any product component or device. In the event of such removal or alteration, this warranty is void.
- j) Any expense related to delivery or pick-up of product to/from the service dealer.

4. RESPONSIBILITIES OF THE PURCHASER

IN ORDER FOR THE WARRANTY TO BE HONORED, THE PURCHASER MUST HAVE PROOF OF PURCHASE: THE ORIGINAL RECEIPT OR THE WARRANTY CARD ON FILE AT CAREFREE OF COLORADO. FAILURE TO PROVIDE THE REQUIRED DOCUMENTATION MAY DELAY OR VOID ANY WARRANTY CLAIM.

- a) Retain dated proof of purchase for specified product, and provide it as requested.
- b) Inspect the shade upon purchase to confirm the condition of the canopy, hardware and proper operation of the product.
- c) Perform "Periodic Maintenance" as specified in Owners Manual.
- d) Use reasonable care in maintenance, operation, use and storage of the product in accordance with the instructions contained in the owner's manual.

5. WARRANTY CLAIM PROCEDURE

- a) Deliver any product claimed or found defective during warranty period to a Carefree of Colorado Authorized Service Dealer. Visit www.carefreeofcolorado.com for the name of nearest Authorized Service Dealer, or call Carefree at the phone number shown.
- b) Customer shall schedule a time with an Authorized Service Dealer. Repair or replacement will be scheduled and performed at the Authorized Service Dealer according to normal work flow and availability of replacement parts.
- c) *Work must be performed by a Carefree authorized service center.* When warranty work/repair is performed by an authorized service agent, the agent is responsible for directly billing Carefree of Colorado for warranted parts and labor.
- d) Carefree shall pay the respective servicing dealer or agent for performing any repairs authorized by Carefree as per the terms of this warranty. Company will allow for freight and labor charges - labor is based on Flat Rate Form.
- e) All warranty claims shall be paid through the servicing agent. Carefree does not provide reimbursement for warranty claims paid for by the customer.
- f) The customer shall pay only those costs not covered by warranty. The customer shall have no out-of-pocket expenses except as stated.
- g) The Original Purchaser is responsible for any expenses related to delivery or pick up of product to/from the Service Dealer.
- h) If the Purchaser does not receive satisfactory results from the Authorized Service Dealer, the Purchaser should contact the Carefree of Colorado Customer Care Department within 10 days after completion of the questionable service.

THIS WARRANTY GIVES THE OWNER SPECIFIC LEGAL RIGHTS. THE LAWS OF CERTAIN JURISDICTIONS MAY GRANT THE OWNER ADDITIONAL RIGHTS AND PRIVILEGES. Except as set forth above, Carefree makes no warranty, whether statutory or otherwise, including without limitation, any warranty of merchantability or fitness for a particular purpose. Carefree shall have no liability except to repair, replace or adjust defective products and parts. Carefree specifically excludes any liability, whether in contract, tort or otherwise, for personal injury, property damage, economic or consequential losses. Carefree has not authorized any person or company to alter the terms of this warranty.

It is Carefree of Colorado's policy and practice to continuously improve the company's products and services. Therefore, Carefree reserves the right to make changes in design and components, without notice, whenever it is believed the quality of the product will be improved, but without incurring any obligation to incorporate such improvements in any product which has been shipped or in service.

FOR YOUR RECORDS:

DEALER/INSTALLER

NAME: _____

ADDRESS: _____

PHONE: _____

PURCHASE DATE: _____

PART NUMBER: _____

SERIAL NUMBER: _____

PRODUCT NAME OR DESCRIPTION: _____

Color: _____ **Length:** _____

Register your Carefree products on-line @
www.carefreeofcolorado.com